

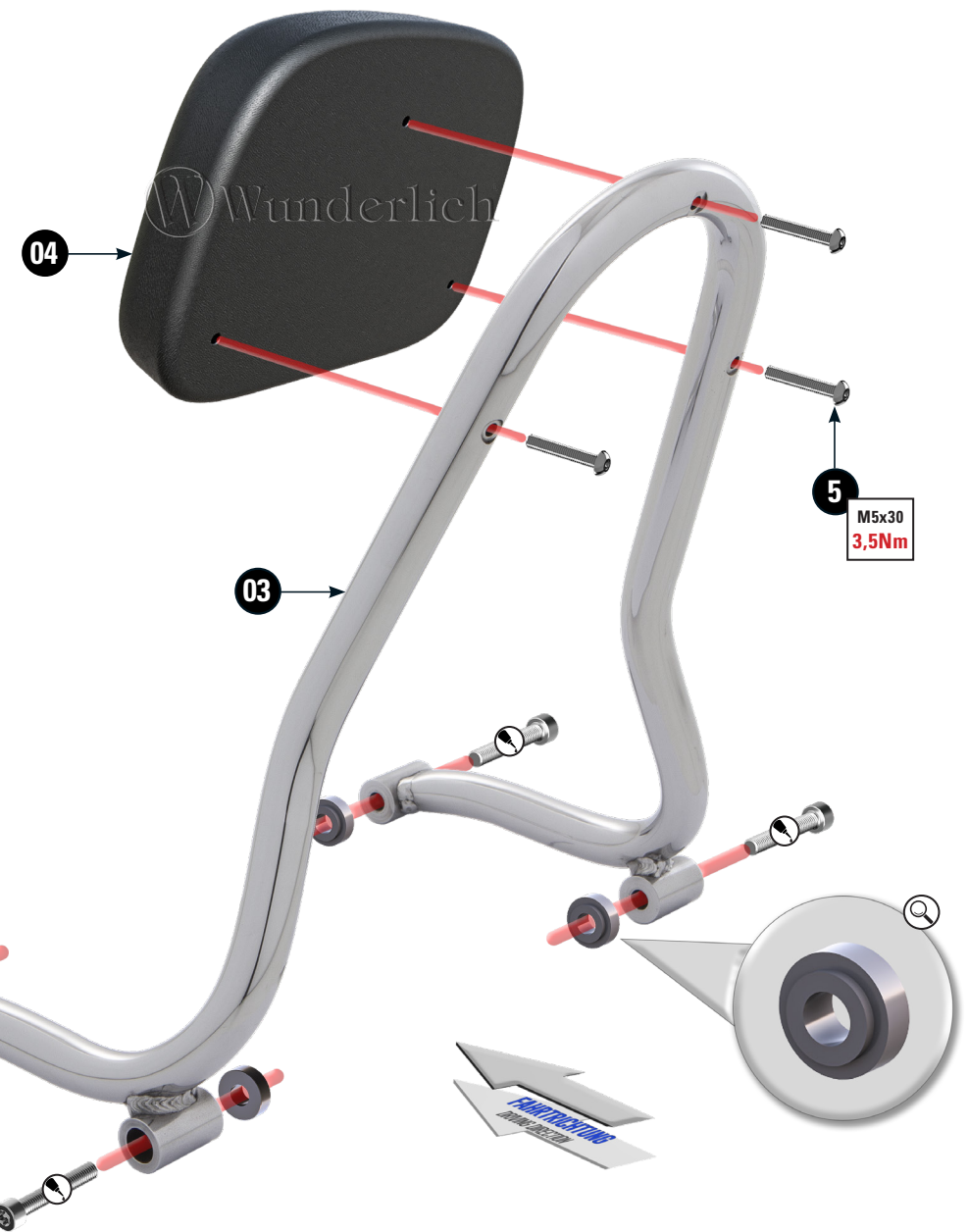





# SISSYBAR

Artikel.-Nr: 18110-00X



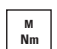

LEGENDE/KEY/FILE LÉGENDE

-  **Anbau Tipp**  
Fitting tip  
Astuce de montage
-  **Achtung**  
Attention  
Attention
-  **Vergrößerung**  
Magnification  
Grossissement
-  **Montagepaste**  
Fitting lubricant  
Lubrifiant de montage
-  **Schraube**  
Screw  
Vis
-  **Schraubensicherung**  
Thread locking fluid  
Freinfilets
-  **Drehmoment**  
Torque  
Torque

#	BEZEICHNUNG / DESCRIPTION	DE / EN / FR	DIN	ISO	MENGE / QUANTITY
1	Zylinderkopfschraube / cylinder head screw M8 x 50 (natur/stainless steel) Optional M8 x 50 (Schwarz/black) 19,0 Nm	Die Farben der Abbildungen dienen nur der Veranschaulichung. The colors are for illustrating purposes only. Les couleurs utilisées sont à titre indicatif seulement.	912Z 912SZ	14579 14579	4 4
2	Stufenhülse / grade sleeve D Ø 21,0 - d Ø 9,0 - h 8,3 mm				4
3	Sissybar				1
4	Rückenpolster / back cushion				1
5	Linsenkopfschraube / panhead screw M5 x 30 (natur/stainless steel) 3,5 Nm Optional M5 x 30 (Schwarz/black)		7380A2 7380SA2	7380A2 7380SA2	3 3

**MARKIERTE FLÄCHEN VOR DER MONTAGE MIT LACKSCHUTZFOLIE ODER ÄHNLICHEM BEKLEBEN.**

-EN Cover the marked areas with paint protection film or similar before assembly.

-FR Recouvrir les zones marquées d'un film de protection de peinture ou d'un produit similaire avant le montage.

